

*Arlington 1-Door
Wardrobe
with Hanger Rod*

Item Number:
ARL24W

Dimensions:
24"W x 22"D x 66"H

GLUED, SCREWED, AND DOWEL
CONSTRUCTION FOR STRUCTURAL STABILITY

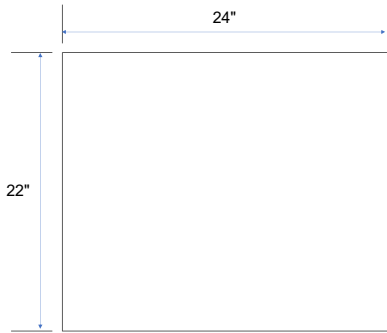

TOP VIEW

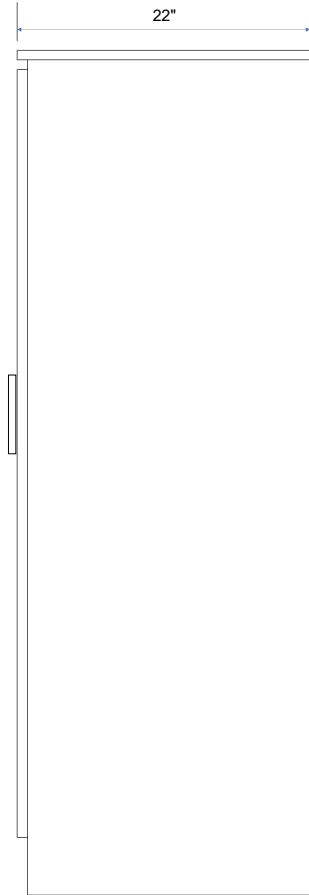

SIDE VIEW

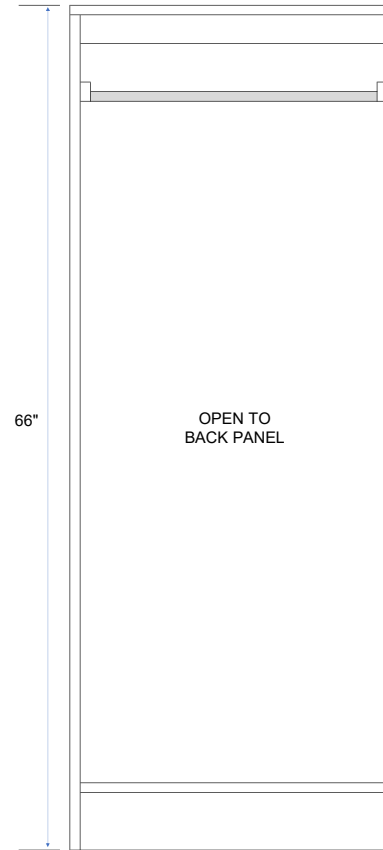

INSIDE VIEW

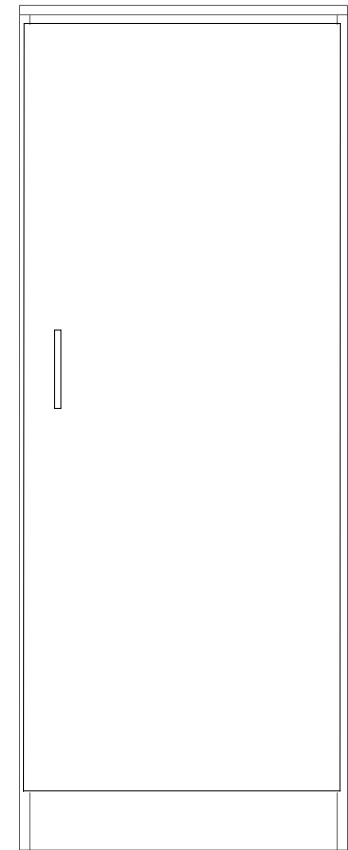

FRONT VIEW

*Arlington 1-Door Wardrobe
with Hanger Rod*

Item Number:
ARL24W

Dimensions:
24"W x 22"D x 66"H

Inside View

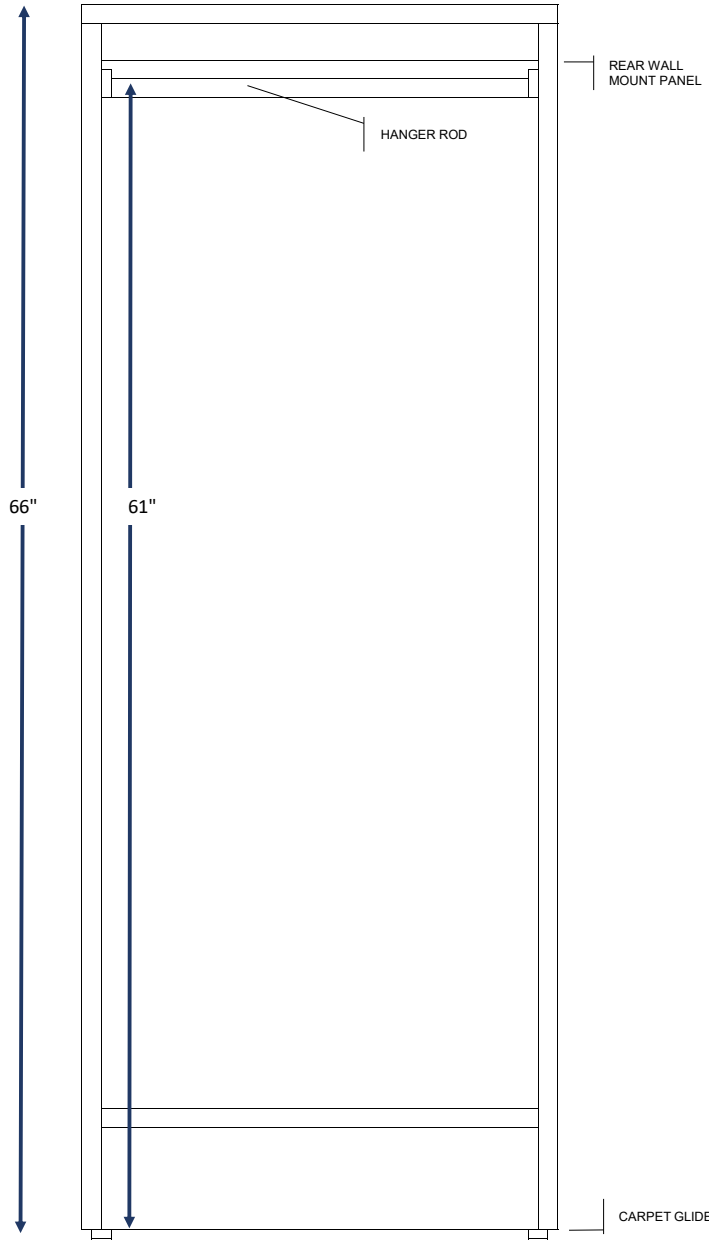

Front View

